

MUZZLE TRAINING YOUR DOG

If your dog needs to wear a muzzle, it's important that they are comfortable wearing one. With some patience, lots of lovely food and the right training approach, your dog will soon learn that their lead and muzzle mean it's time for a walk!



STEP 1:

- Put something tasty like squeezy cheese or pate in the muzzle. Let your dog see you do this.
- Don't do the muzzle up at this stage, just let your dog eat the food and get used to the feel.
- If your dog is worried about putting their face in, let them lick the outside until they feel more confident.
- Do this in various places – in the kitchen, watching telly or when you're in the garden.
- Always let your dog come towards the muzzle, rather than you moving towards them.

Tip: Keep an eye out for that tail wag – once your dog associates their muzzle with getting lots of tasty treats, you'll know they're enjoying it.

STEP 2:

- Help keep their nose in the muzzle for longer by posting treats through.
- Before you move to doing the muzzle up, get them used to the sound by doing the clip up while the muzzle is off and giving them a tasty treat.



Tip: Take your time with short, regular sessions, and save their favourite treats for when the muzzle comes out.





STEP 3:

- When your dog is ready, do the muzzle up. Feed them through the muzzle, then take it off straight away.
- Gradually leave it on for longer. Start with two seconds and build up slowly, making sure you are using plenty of treats.

Tip: Only give treats when the muzzle is on, stop feeding when you take the muzzle off. Muzzle = treats!

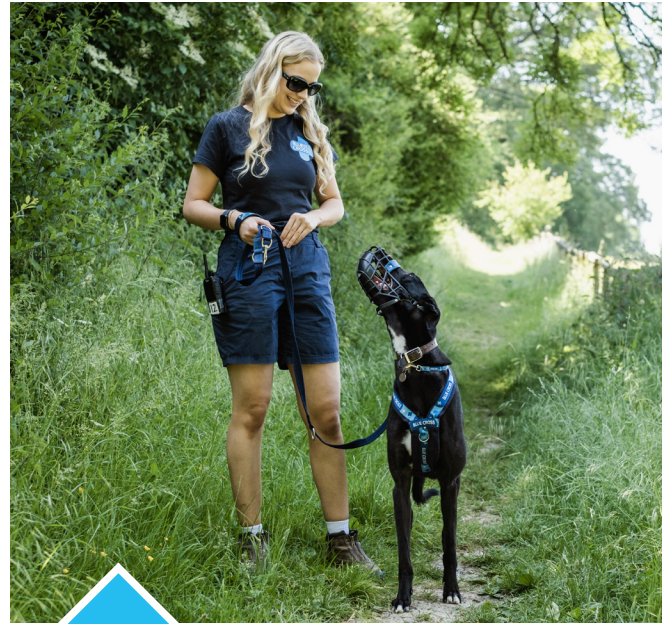

STEP 4

- Once your dog is comfortable with the muzzle on, make things fun by moving around, changing direction and giving plenty of treats to tell them how well they're doing.
- You can then progress to attaching their lead to get them used to walking next to you while wearing their muzzle.

Tip: If your dog tries to remove their muzzle, distract them by showing them some food, and reward them when they stop. You might need to go back a stage.

REMEMBER:



Take your time – some dogs need longer than others to get used to their muzzle.



Train in lots of different places and times of the day. Keep sessions short but frequent.



Aim to get their tail wagging during muzzle training.



If you need help or advice contact us:
Telephone 0300 790 9903
or email info@bluecross.org.uk

For more information on muzzle training or to see our muzzle training video scan the QR code.

bluecross.org.uk

Registered charity no. 224392 (England and Wales), SC040154 (Scotland).



Pets change lives
We change theirs

FINDING THE RIGHT MUZZLE FOR YOUR DOG

If your dog needs to wear a muzzle, it's important to make sure the type of muzzle they wear is comfortable and safe.

We find basket muzzles like the Baskerville muzzle are a good option for large breeds. You can buy these from most pet stores or online. Prices range from £15-£50 depending on size and type.

Muzzle requirements

When wearing a muzzle, your dog must be able to:



1. Breathe easily



2. Open their mouth and pant



3. Be able to drink when the muzzle is on

Fabric muzzles will not allow these three basic requirements, so will not be a safe option for your dog.



Measuring your dog's muzzle

To find out what size muzzle your dog will need, you'll need to take some measurements. What measurements you take will depend on the brand and style, so make sure you read the guidelines given. Use a soft tape measure or a piece of string.

Measuring your dog's muzzle may seem a bit strange to them, so take your time getting them used to the string or tape measure. If your dog is a bit worried by the tape measure, it might be helpful to ask someone to assist you, by feeding your dog a few treats!

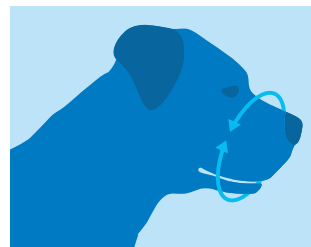

Measure all the way around the nose. Make sure you measure just below the eyes



Measure the end of the nose to the top, just below the eyes

Checking your muzzle fits

A well-fitting muzzle needs to:

- Not rub or dig into your dog's face
- Have the straps snug but not tight. You should be able to get your finger underneath
- Have enough space around your dog's face so they can open their mouth, pant and drink

Tip: Applying a layer of thin fleece where the muzzle makes contact with your dog's skin can help to reduce any chances of rubbing. Especially if your dog doesn't have huge amounts of fur there.

If the muzzle fit doesn't seem quite right for your dog, one of the great things about a Baskerville Ultra muzzle is they can be moulded to improve the fit.

To mould the muzzle you will need to:

1. Warm the muzzle in very hot tap water for 2-3 minutes
2. Carefully take out and once cool to touch, reshape the muzzle
3. Place in cold water for 30 seconds to keep the new shape
4. Once cool, check for fit and repeat process if needed

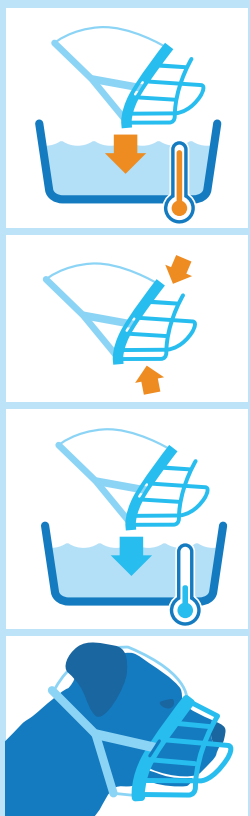

Get creative and customise your muzzle

A muzzle is now very much a part of your dog's life, adding a bit of colour by popping some bright or patterned pet friendly tape on the muzzle can help to change the stigma of being in a muzzle. Just make sure it doesn't get in the way of your dog seeing.



If you can't find a muzzle to fit your dog comfortably, then there are companies who can offer custom fit muzzles. These will be more expensive, but worth a try.



If you need help or advice contact us on
Telephone 0300 790 9903
or email info@bluecross.org.uk

For more information on muzzle training or to see our muzzle training video scan the QR code.

bluecross.org.uk

Registered charity no. 224392 (England and Wales), SC040154 (Scotland).



Pets change lives
We change theirs